

**CITY OF NAPOLEON
BUILDING CONSTRUCTION PERMIT**

Permit No. 531-76

Issued June 11, 1976

By [Signature] Building Inspector

Owner Name Water Truck Stop

Address Co. Rd. 12 @ U.S. 6 & 24

Builder Name Mal Lenzon Co.

Address 2266 N. Scott St. Tel. 592-2901

Lot Information:

Street No. Co. Rd. 12 @ U.S. 6 & 24

Lot Subdivision

Lot Dimensions Lot Area Sq. Ft.

Yard Set Back: Front Rear

Side Side

Zoning District "R-1"

Building Information:

Intended use of Building New Kitchen & Storm Entry

O.B.C. Occupancy Chapter 88-43

Residential No. of Units Commercial Industrial

New Construction Alteration Addition Remodel

Size: Length 14'0" Width 9'8" No. of Stories

Floor Area: 1st Floor 186 sq. ft. 2nd Floor 3rd Floor Basement

Foundation: Piers Full Basement Part Basement

EXISTING Concrete Slab Block

Wall: Frame Metal Block Brick Other

Electrical Work to be done: Wiring of the required exit signs as noted on plan

examine's Addendum. Subject to electrical inspection.

Additional Information: This permit requires compliance with the attached addendum

safe & part basement.

Date 6/14/76 Applicant Signature [Signature] Owner - Builder - Agent

Inspection Record:

Work Started Foundations Final Electrical

Set Back, Side Lines Erecting Frame Heating

Excavation Electrical Rough In Air Conditioning

Footing Electrical Service Final Structural

Comments:

Certificate of Occupancy Issued Inspector

White - Applicant Yellow - Crk. Treas. Pink - Eng. Green - Elec. Insp. Gold - Co. Auditor

Estimated Cost \$2,000.00

Fees Structural \$25.00 Base Plus Total \$2,025.00

Electrical

Water Tap

Sewer Tap

Temporary Electric

Additional Plan Review 0 hrs.

TOTAL FEES \$2,025.00

Less Minimum Fees Paid

BALANCE DUE None

June 11, 1976

ADDENDUM TO PLAN APPROVAL
NATCO TRUCK STOP NO.531-76

Mr. Thomas W. Terranova
Building and Zoning Inspector
City of Napoleon
P.O. Box 151
Napoleon, Ohio 43545

This addendum is attached to and is a part of the plans. All items listed below will be performed and will be incorporated into the structure.

1. A Type A exit sign shall be installed inside the kitchen storm enclosure at the exit door in accordance with Section BB-23-69 of the Ohio Building Code.
2. The exit from the kitchen storm enclosure shall be provided with Type A or B hardware in accordance with Section BB-63-13 of the Ohio Building Code.

Plan Approval will be valid only upon signing of this Addendum by the Owner or his authorized representative. If there are any questions feel free to contact the office of City Building Inspector.

Max Catehart

Authorized Signature

Draftsman

Title

RCJ:fbh

City of Napoleon
Engineering Department
P. O. Box 151 - 255 W. Riverview Ave.
Napoleon, Ohio 43545

No. 5-11-76

Date 6-11-76

CERTIFICATE OF

- Structural Plan Approval
- Electrical Plan Approval
- Special Plan Approval

Submitted
By:

Natco Truck Stop
Corner U.S. 24 & Co. Rd. 12
Napoleon, Ohio 43545

- Architect
- Engineer
- Other
- New
- Addition
- Alteration
- Mixed Occupancy
- Change of Occupancy

NAME AND LOCATION OF JOB

Natco Truck Stop
Corner U.S. 24 & Co. Rd. 12
Napoleon, Ohio 43545

OWNER'S AGENT

Me1 Lanzer Company
2266 North Scott Street
Napoleon, Ohio 43545

TYPE OF CONSTRUCTION (Where Applicable) Type IV Ordinary Construction

O.B.C. Type of Occupancy BB-63 Stories One

Basement No

Inspections shall be called for by the builder 48 hours in advance before work is covered. Final inspection must be made before building can be used or occupied. THIS CERTIFICATE SHALL REMAIN POSTED IN A CONSPICUOUS AND SAFE PLACE UNTIL COMPLETION OF JOB. APPROVED PLANS MUST BE KEPT ON JOB SITE AT ALL TIMES DURING CONSTRUCTION.

Plans, specifications and/or application as described above are hereby approved with addendum.

Date of Approval June 11, 1976

BY: Robert H. Jones PLAN EXAMINER

This approval does not cover the water supply, plumbing and drainage. Plans and specifications for this class of work shall be submitted to the Division of Plumbing, State Department of Health for examination and approval. For approval of pressure piping, contact the Division of Pressure Piping, 2323 W. Fifth Ave., Columbus, Ohio. Zoning for Napoleon is not included in this approval.

White - Applicant

Yellow - Plan Examiner

Pink - Engineering

APPLICATION FOR PERMIT TO TAP SEWER

No. 402 Date 8-24, 1971

Name Norman Tiplady

Address Route 1 Box 1415 Swanton, Ohio

LOCATION OF CONNECTION

Street and Number Corn Road 12 + Road R

Lot No. _____ Addition _____

Date work will start _____ (All work must be inspected)

Work will be done by _____

I certify that the sewer will be used only as indicated and no other drainage will be connected.

Applicant Norman Tiplady

Date 8-24-71 Address _____

Permit Fee \$ 60.00
pd 8-24-71 Robert W. Schweindagen
Certification by City Clerk

Work inspected _____

Work completed _____

Remarks _____

SEWER INSPECTION

No. _____ Napoleon, Ohio Date _____ 19 _____

Received of _____

_____ Dollars

Charge for tapping permit to supply sewer service to Lot No. _____

Addition _____

Street No. Corn Road 12 to Road R

Sewer Size 6" inch Cost _____

Size and Kind of Main Sewer 10" VSP

Location of Main Sewer 12 feet from Center of Road North

Depth of Main Sewer 10' deep

Date Sept 14-1971 Date Sept 14-1971
 Street 6 Size and Kind of Sewer 10 IPS
 Old No. 12 feet north of Center of Road
 New No. 10 Feet deep
 Crossover 14 Distance to Curb Stop

Remarks

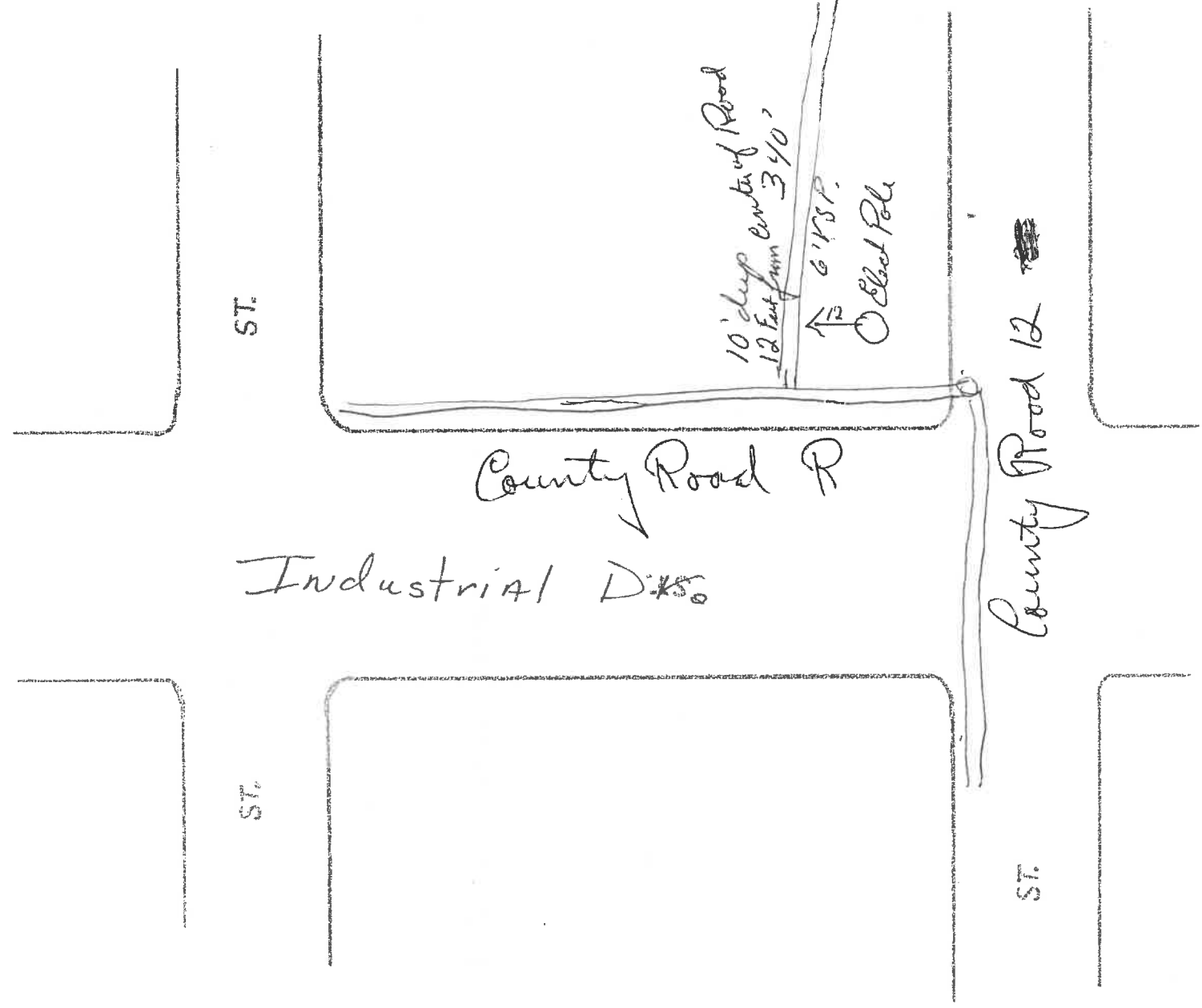

CITY OF NAPOLEON
ENGINEERING DEPARTMENT

SIGN PERMIT

(Please Print or Type)

Owner's Name NATCO
Address PO Box 788

Builder Harmon Sign Address 559 Shoop Udonson Tel. 335-2856

SIGN BILLBOARD AWNING MARQUEE

Location of Project: ~~State~~ US 6 & 24 County Rd 12

Additional Information: One circuit 170V 11.7 Amps Robbins

Dimensions 7'x12' Square Feet 84

Date 8/15/77
Signature of Applicant [Signature]

Application Must Be Accompanied with Sketch and Description of Proposed Installation

White - Applicant Yellow - Clerk-Treasurer Pink - Engineering Gold - County Auditor

Do Not Write With. Boxed Area.
For Engineering Office Use Only.
Permit No. 67-775
Issued 8/16/77

By [Signature]
Estimated Cost
Base Fee
Add
Total Fee